

- ① MAKE SURE THE CROWN AND PANEL MATCH
- ② LAY CARTONS ON FLOOR TO PROTECT PANEL
- ③ PUT PANEL ON ITS SIDE THEN SLIDE CROWN IN PLACE
- ④ ATTACH CROWN TO PANEL WITH SUPPLIED NUTS, WASHERS AND BOLTS

**AWP-- CROWN AND PANEL MATCHING**

**1** ATTACHE BACK FRAME TO WALL  
USING THE SUPPLIED SCREWS AND  
WASHERS

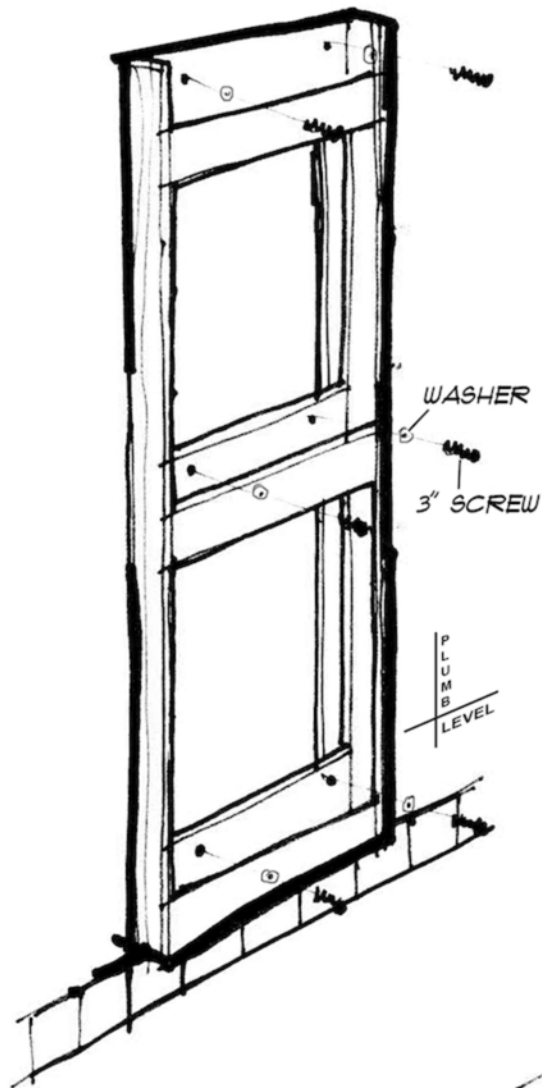

**4**  
↓  
LOWER THE PANEL  
CAREFULLY

**3**  
↑  
LIFT THE PANEL UP  
AT LEAST 1" FROM  
THE BASE

**2**  
←  
GET THE PANEL ON  
WDC BASE THEN PRESS  
IT AGAINST THE BACK  
FRAME

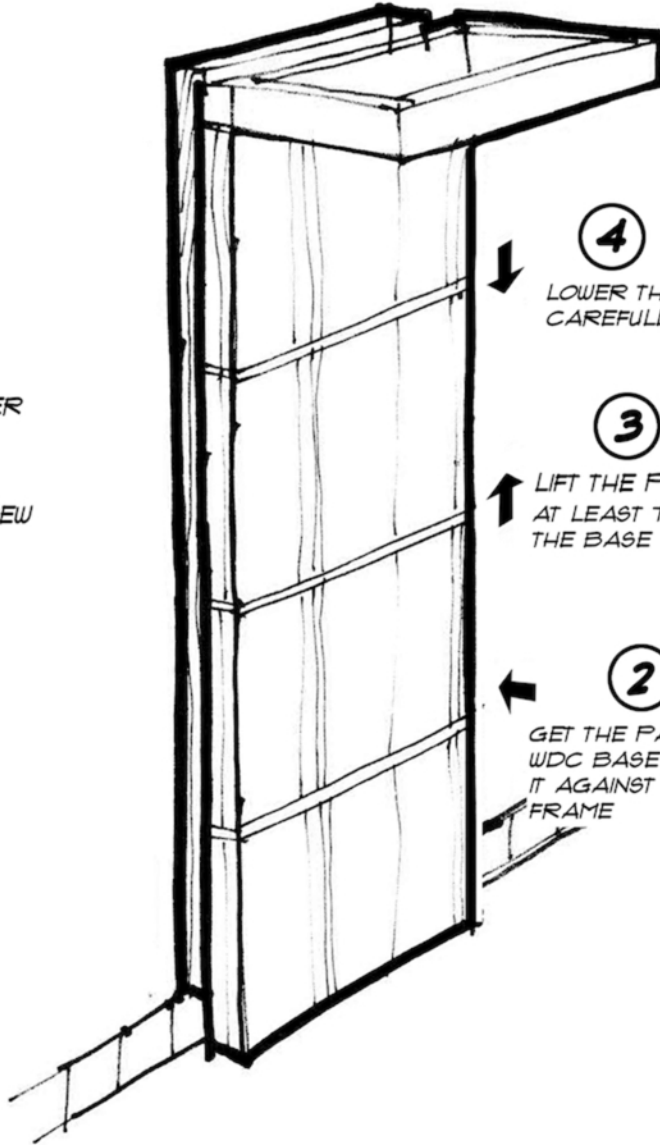

## **AWP INSTALLATION GUIDE**

### **BEFORE INSTALLING AWP:**

CHECK FLOOR PLAN FOR THE EXACT LOCATION

MAKE SURE THE WALL HAS BACKING

WALL PANEL IS TOP HEAVY, YOU NEED THREE PEOPLE TO INSTALL THE AWP

**1** ATTACHE BACK FRAME TO WALL USING THE SUPPLIED SCREWS AND WASHERS

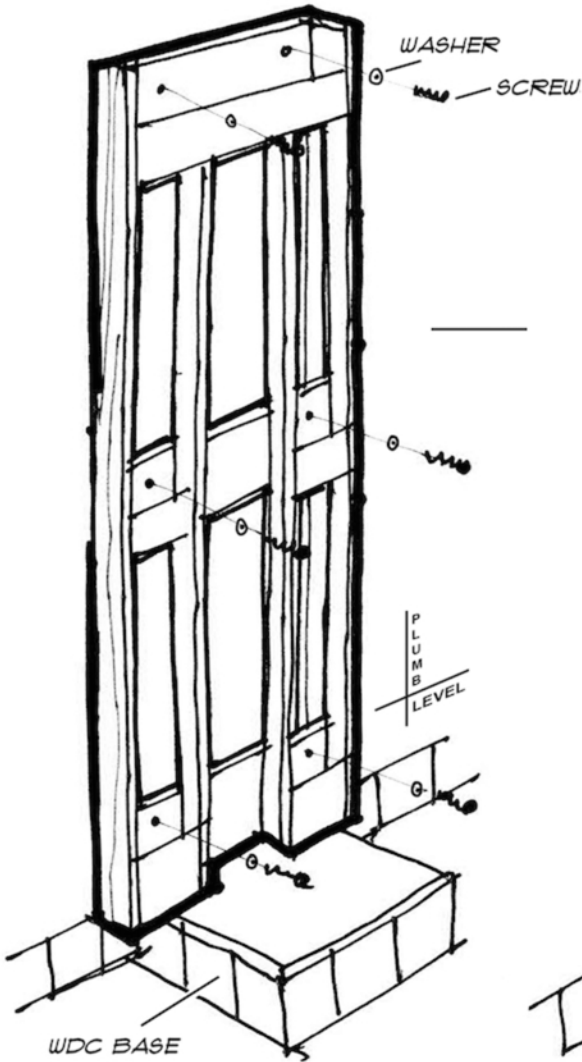

**4** LOWER THE PANEL CAREFULLY

**3** LIFT THE PANEL UP AT LEAST 1" FROM THE BASE

**2** GET THE PANEL ON WDC BASE THEN PRESS IT AGAINST THE BACK FRAME

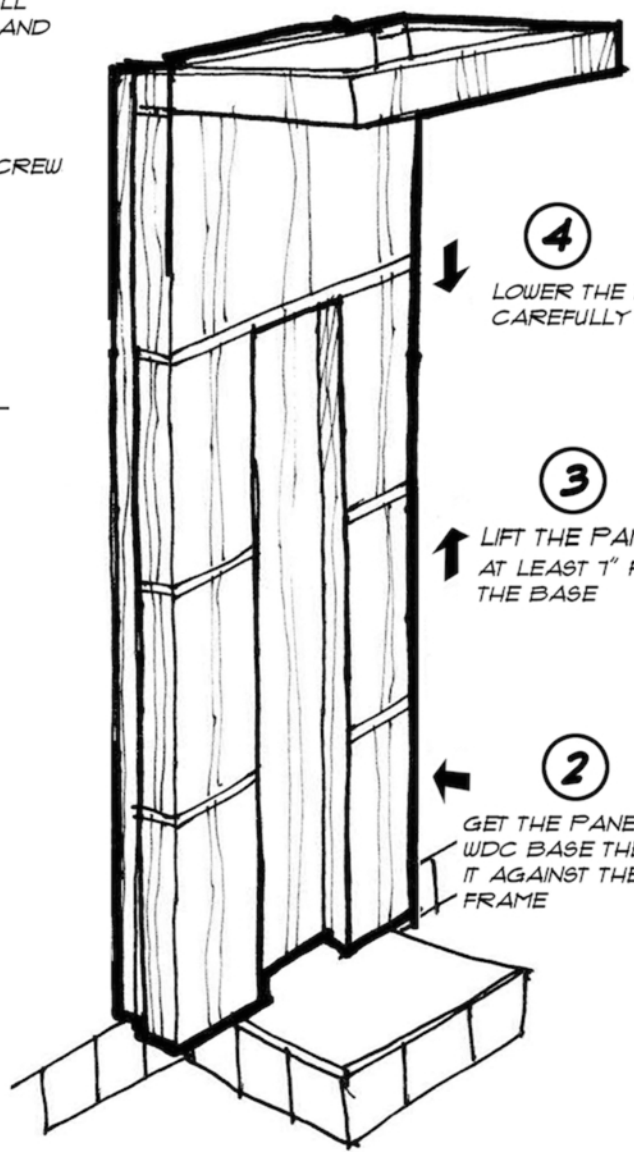

MASKING TAPE

**7** ATTACH BACK SPLASH WITH SILCONE OR LIQUID NAIL STARTING WITH THE MIDDLE PART THEN THE SIDES. USE MASKING TAPE TO AVOID MOVEMENT

**6** INSTALL COUNTER TOP TO BASE USING SILCONE OR LIQUID NAIL

**5** REMOVE DOORS THEN ATTACH WDC TO AWP AND BASE

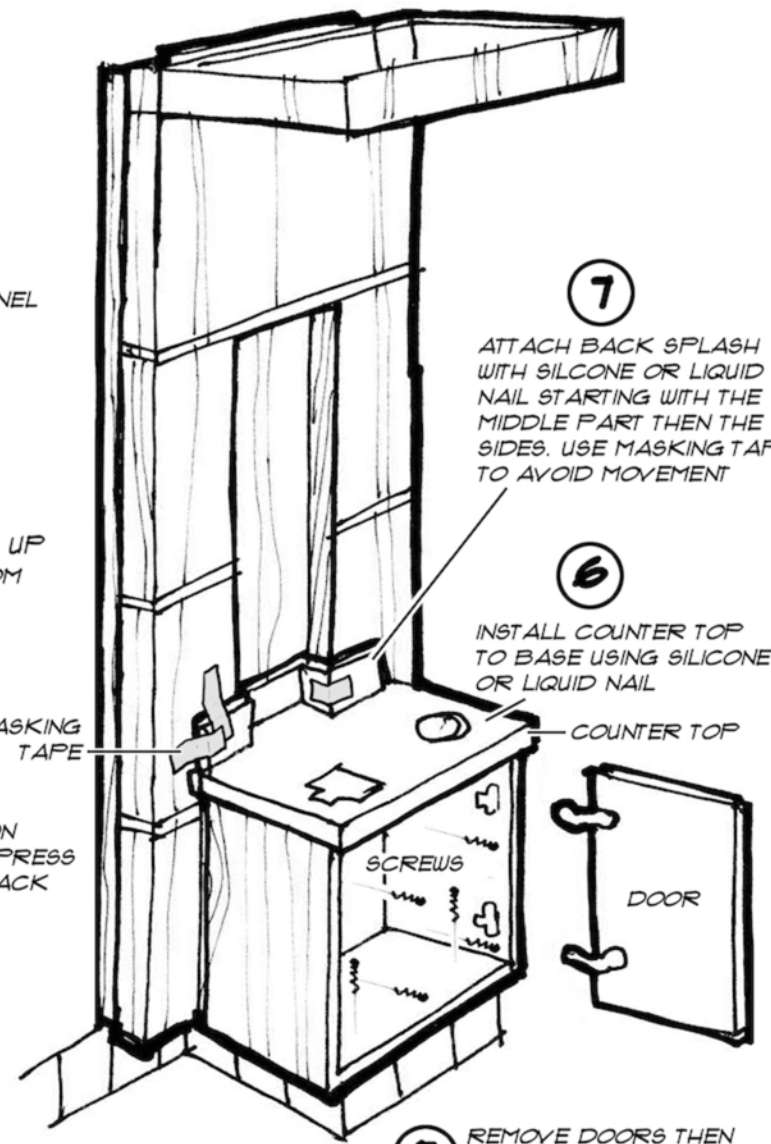

**AWP/WDC INSTALLATION GUIDE**

**BEFORE INSTALLING AWP:**  
 CHECK FLOOR PLAN FOR THE EXACT LOCATION  
 MAKE SURE THE WALL HAS BACKING  
 WALL PANEL IS TOP HEAVY, YOU NEED THREE PEOPLE TO INSTALL THE AWP